

CA Series Flat Spray Nozzles

CA

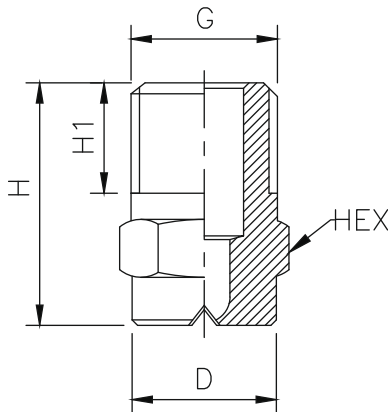

Standard design with self sealing thread connection. Stable spray angle, Uniform distribution of liquid, parabolical distribution of liquid.

Design : One piece construction, Non clogging type.

Application : Rinsing, Lubricating, Industrial washing machines, Cake washing in Centrifuge, CIP, Tray washing.

'C' Series Flat Spray Nozzles are designed for high pressure / high impact washing application. These nozzles are specially designed and machined with precision which allows even spray coverage and distribution. This results in effective and uniform cleaning action over the surface being processed. Flat spray nozzles are available in all steel grades, Plastics & other alloys. Spray angle range available from 15° to 120°

15° SPRAY ANGLE	CONNECTION END		ORIFICE SIZE (mm)	FLOW CAPACITY IN LPM AT DIFFERENT PRESSURE								G/A DIMENSION. MM				
	1/8"	1/4"		PRESSURE [BAR]												
MODEL NO.	BSP BSPT NPT	BSP BSPT NPT		0.5	1.0	2.0	3.0	5.0	7.0	10.0	15.0	CONN.	H	H1	D	HEX
CA11.050	●	●	0.8	0.25	0.35	0.50	0.61	0.79	0.94	1.12	1.37	1/8"	18	6.5	10.2	11
CA11.075	●	●	1.0	0.37	0.53	0.75	0.92	1.19	1.40	1.68	2.05	1/8" Weight (Metals) = 7 gms. Approx				
CA11.100	●	●	1.2	0.50	0.71	1.00	1.22	1.58	1.87	2.24	2.74	1/4"	22	10	13	14
CA11.150	●	●	1.5	0.75	1.06	1.50	1.84	2.37	2.81	3.35	4.11	1/4" Weight (Metals) = 18 gms. Approx				
CA11.175	●	●	1.6	0.87	1.24	1.75	2.14	2.77	3.27	3.91	4.79					
CA11.200	●	●	1.7	1.00	1.41	2.00	2.45	3.16	3.74	4.47	5.48					
CA11.250	●	●	1.9	1.25	1.77	2.50	3.06	3.95	4.68	5.59	6.85					
CA11.300	●	●	2.1	1.5	2.12	3.0	3.67	4.74	5.61	6.71	8.22					
CA11.350	●	●	2.3	1.75	2.47	3.50	4.29	5.53	6.55	7.83	9.59					
CA11.400	●	●	2.4	2.00	2.83	4.00	4.90	6.32	7.48	8.94	10.95					
CA11.475	●	●	2.7	2.37	3.36	4.75	5.82	7.51	8.89	10.62	13.00					
CA11.650	●	●	3.1	3.25	4.60	6.50	7.96	10.28	12.16	14.53	17.80					
CA11.800	●	●	3.5	4.00	5.66	8.00	9.80	12.65	14.97	17.89	21.91					
CA21.100		●	3.9	5.00	7.07	10.00	12.25	15.81	18.71	22.36	27.39					
CA21.125		●	4.3	6.25	8.84	12.50	15.31	19.76	23.39	27.95	34.23					
CA21.160		●	4.9	8.00	11.31	16.00	19.60	25.30	29.93	35.78	43.82					
CA21.180		●	5.2	9.00	12.73	18.00	22.05	28.46	33.67	40.25	49.30					
CA21.200		●	5.5	10.00	14.14	20.00	24.49	31.62	37.42	44.72	54.77					
CA21.225		●	5.8	11.25	15.91	22.50	27.56	35.58	42.09	50.31	61.62					
CA21.250		●	6.1	12.50	17.68	25.00	30.62	39.53	46.77	55.90	68.47					

CA Series Flat Spray Nozzles

Standard design with connection suitable spray angle uniform distribution of liquid. The internal geometry of each nozzles is specifically engineered to provide maximum uniformity of the spray angle and flow rate.

Application :

- Spray Coating
- Lubricating
- Circuit Board Rinsing
- Metal Processing
- Part Washing

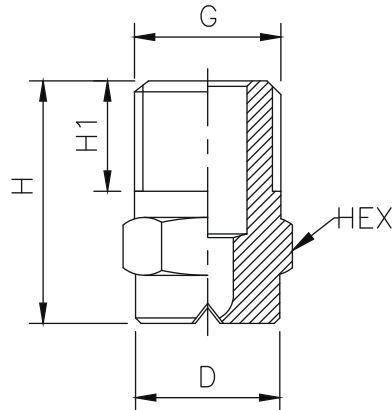

Headers



30° SPRAY ANGLE	CONNECTION END		ORIFICE SIZE (mm)	FLOW CAPACITY IN LPM AT DIFFERENT PRESSURE								G/A DIMENSION. MM				
	1/8"	1/4"		PRESSURE [BAR]								CONN.	H	H1	D	HEX
MODEL NO.	BSP BSPT NPT	BSP BSPT NPT		0.5	1.0	2.0	3.0	5.0	7.0	10.0	15.0					
CA12.050	●	●	0.8	0.25	0.35	0.50	0.61	0.79	0.94	1.12	1.37	1/8"	18	6.5	10.2	11
CA12.075	●	●	1.0	0.37	0.53	0.75	0.92	1.19	1.40	1.68	2.05	1/8" Weight (Metals) = 7 gms. Approx				
CA12.100	●	●	1.2	0.50	0.71	1.00	1.22	1.58	1.87	2.24	2.74	1/4"	22	10	13	14
CA12.150	●	●	1.5	0.75	1.06	1.50	1.84	2.37	2.81	3.35	4.11	1/4" Weight (Metals) = 18 gms. Approx				
CA12.175	●	●	1.6	0.87	1.24	1.75	2.14	2.77	3.27	3.91	4.79					
CA12.200	●	●	1.7	1.00	1.41	2.00	2.45	3.16	3.74	4.47	5.48					
CA12.250	●	●	1.9	1.25	1.77	2.50	3.06	3.95	4.68	5.59	6.85					
CA12.300	●	●	2.1	1.5	2.12	3.0	3.67	4.74	5.61	6.71	8.22					
CA12.350	●	●	2.3	1.75	2.47	3.50	4.29	5.53	6.55	7.83	9.59					
CA12.400	●	●	2.4	2.00	2.83	4.00	4.90	6.32	7.48	8.94	10.95					
CA12.475	●	●	2.7	2.37	3.36	4.75	5.82	7.51	8.89	10.62	13.00					
CA12.650	●	●	3.1	3.25	4.60	6.50	7.96	10.28	12.16	14.53	17.80					
CA12.800	●	●	3.5	4.00	5.66	8.00	9.80	12.65	14.97	17.89	21.91					
CA22.100		●	3.9	5.00	7.07	10.00	12.25	15.81	18.71	22.36	27.39					
CA22.125		●	4.3	6.25	8.84	12.50	15.31	19.76	23.39	27.95	34.23					
CA22.160		●	4.9	8.00	11.31	16.00	19.60	25.30	29.93	35.78	43.82					
CA22.180		●	5.2	9.00	12.73	18.00	22.05	28.46	33.67	40.25	49.30					
CA22.200		●	5.5	10.00	14.14	20.00	24.49	31.62	37.42	44.72	54.77					
CA22.225		●	5.8	11.25	15.91	22.50	27.56	35.58	42.09	50.31	61.62					
CA22.250		●	6.1	12.50	17.68	25.00	30.62	39.53	46.77	55.90	68.47					

* Flow rate in US GPM @40 psi Pressure

CA Series Flat Spray Nozzles

45° SPRAY ANGLE	END CONNECTION				ORIFICE SIZE (mm)	FLOW CAPACITY IN LPM AT DIFFERENT PRESSURE VALUES								G/A DIMENSION. MM				
	1/8"	1/4"	3/8"	1/2"		PRESSURE [BAR]								CONN.	H	H1	D	HEX
MODEL NO.	BSP BSPT NPT	BSP BSPT NPT	BSP BSPT NPT	BSP BSPT NPT		0.5	1.0	2.0	3.0	5.0	7.0	10.0	15.0					
CA13.050	●	●			0.8	0.25	0.35	0.50	0.61	0.79	0.94	1.12	1.37	1/8"	18	6.5	10	11
CA13.075	●	●			1.0	0.37	0.53	0.75	0.92	1.19	1.40	1.68	2.05	1/8" Weight (Metals) = 7 gms. Approx				
CA13.100	●	●			1.2	0.50	0.71	1.00	1.22	1.58	1.87	2.24	2.74	1/4"	22	10	13	14
CA13.150	●	●			1.5	0.75	1.06	1.50	1.84	2.37	2.81	3.35	4.11	1/4" Weight (Metals) = 18 gms. Approx				
CA13.175	●	●			1.6	0.87	1.24	1.75	2.14	2.77	3.27	3.91	4.79	3/8"	25	12	16	17
CA13.200	●	●			1.7	1.00	1.41	2.00	2.45	3.16	3.74	4.47	5.48	3/8" Weight (Metals) = 28 gms. Approx				
CA13.250	●	●			1.9	1.25	1.77	2.50	3.06	3.95	4.68	5.59	6.85	1/2"	27	13.2	21	22
CA13.300	●	●			2.1	1.5	2.12	3.00	3.67	4.74	5.61	6.71	8.22	1/2" Weight (Metals) = 42 gms. Approx				
CA13.350	●	●			2.3	1.75	2.47	3.50	4.29	5.53	6.55	7.83	9.59					
CA13.400	●	●			2.4	2.00	2.83	4.00	4.90	6.32	7.48	8.94	10.95					
CA13.475	●	●			2.7	2.37	3.36	4.75	5.82	7.51	8.89	10.62	13.00					
CA13.650	●	●			3.1	3.25	4.60	6.50	7.96	10.28	12.16	14.53	17.80					
CA13.800	●	●			3.5	4.00	5.66	8.00	9.80	12.65	14.97	17.89	21.91					
CA23.100		●	●		3.9	5.00	7.07	10.00	12.25	15.81	18.71	22.36	27.39					
CA23.125		●	●		4.3	6.25	8.84	12.50	15.31	19.76	23.39	27.95	34.23					
CA23.160		●	●		4.9	8.00	11.31	16.00	19.60	25.30	29.93	35.78	43.82					
CA23.180		●	●		5.2	9.00	12.73	18.00	22.05	28.46	33.67	40.25	49.30					
CA23.200		●	●		5.5	10.00	14.14	20.00	24.49	31.62	37.42	44.72	54.77					
CA23.225		●	●		5.8	11.25	15.91	22.50	27.56	35.58	42.09	50.31	61.62					
CA23.250		●	●		6.1	12.50	17.68	25.00	30.62	39.53	46.77	55.90	68.47					
CA23.320			●	●	6.4	16.00	22.63	32.00	39.19	50.60	59.87	71.55	87.64					
CA23.400			●	●	7.8	20.00	28.28	40.00	48.99	63.25	74.83	89.44	109.54					
CA23.520				●	8.9	26.00	36.77	52.00	63.69	82.22	97.28	116.28	142.41					
CA23.650				●	9.9	32.50	45.96	65.00	79.61	102.77	121.60	145.34	178.00					
CA23.800				●	11.0	40.00	56.57	80.00	97.98	126.49	149.67	178.89	219.09					

60° SPRAY ANGLE	END CONNECTION				ORIFICE SIZE (mm)	FLOW CAPACITY IN LPM AT DIFFERENT PRESSURE VALUES								G/A DIMENSION. MM				
	1/8"	1/4"	3/8"	1/2"		PRESSURE [BAR]								CONN.	H	H1	D	HEX
MODEL NO.	BSP BSPT NPT	BSP BSPT NPT	BSP BSPT NPT	BSP BSPT NPT		0.5	1.0	2.0	3.0	5.0	7.0	10.0	15.0					
CA14.050	●	●			0.8	0.25	0.35	0.50	0.61	0.79	0.94	1.12	1.37	1/8"	18	6.5	10	11
CA14.075	●	●			1.0	0.37	0.53	0.75	0.92	1.19	1.40	1.68	2.05	1/8" Weight (Metals) = 7 gms. Approx				
CA14.100	●	●			1.2	0.50	0.71	1.00	1.22	1.58	1.87	2.24	2.74	1/4"	22	10	13	14
CA14.150	●	●			1.5	0.75	1.06	1.50	1.84	2.37	2.81	3.35	4.11	1/4" Weight (Metals) = 18 gms. Approx				
CA14.175	●	●			1.6	0.87	1.24	1.75	2.14	2.77	3.27	3.91	4.79	3/8"	25	12	16	17
CA14.200	●	●			1.7	1.00	1.41	2.00	2.45	3.16	3.74	4.47	5.48	3/8" Weight (Metals) = 28 gms. Approx				
CA14.250	●	●			1.9	1.25	1.77	2.50	3.06	3.95	4.68	5.59	6.85	1/2"	27	13.2	21	22
CA14.300	●	●			2.1	1.50	2.12	3.00	3.67	4.74	5.61	6.71	8.22	1/2" Weight (Metals) = 42 gms. Approx				
CA14.350	●	●			2.3	1.75	2.47	3.50	4.29	5.53	6.55	7.83	9.59					
CA14.400	●	●			2.4	2.00	2.83	4.00	4.90	6.32	7.48	8.94	10.95					
CA14.475	●	●			2.7	2.37	3.36	4.75	5.82	7.51	8.89	10.62	13.00					
CA14.650	●	●			3.1	3.25	4.60	6.50	7.96	10.28	12.16	14.53	17.80					
CA14.800	●	●			3.5	4.00	5.66	8.00	9.80	12.65	14.97	17.89	21.91					
CA24.100		●	●		3.9	5.00	7.07	10.00	12.25	15.81	18.71	22.36	27.39					
CA24.125		●	●		4.3	6.25	8.84	12.50	15.31	19.76	23.39	27.95	34.23					
CA24.160		●	●		4.9	8.00	11.31	16.00	19.60	25.30	29.93	35.78	43.82					
CA24.180		●	●		5.2	9.00	12.73	18.00	22.05	28.46	33.67	40.25	49.30					
CA24.200		●	●		5.5	10.00	14.14	20.00	24.49	31.62	37.42	44.72	54.77					
CA24.225		●	●		5.8	11.25	15.91	22.50	27.56	35.58	42.09	50.31	61.62					
CA24.250		●	●		6.1	12.50	17.68	25.00	30.62	39.53	46.77	55.90	68.47					
CA24.320			●	●	6.4	16.00	22.63	32.00	39.19	50.60	59.87	71.55	87.64					
CA24.400			●	●	7.8	20.00	28.28	40.00	48.99	63.25	74.83	89.44	109.54					
CA24.520				●	8.9	26.00	36.77	52.00	63.69	82.22	97.28	116.28	142.41					
CA24.650				●	9.9	32.50	45.96	65.00	79.61	102.77	121.60	145.34	178.00					
CA24.800				●	11.0	40.00	56.57	80.00	97.98	126.49	149.67	178.89	219.09					

CA Series Flat Spray Nozzles

90° SPRAY ANGLE	END CONNECTION				ORIFICE SIZE (mm)	FLOW CAPACITY IN LPM AT DIFFERENT PRESSURE VALUES								G/A DIMENSION. MM				
	1/8"	1/4"	3/8"	1/2"		PRESSURE [BAR]												
MODEL NO.	BSP BSPT NPT	BSP BSPT NPT	BSP BSPT NPT	BSP BSPT NPT		0.5	1.0	2.0	3.0	5.0	7.0	10.0	15.0	CONN.	H	H1	D	HEX
CA16.050	●	●			0.8	0.25	0.35	0.50	0.61	0.79	0.94	1.12	1.37	1/8"	18	6.5	10	11
CA16.075	●	●			1.0	0.37	0.53	0.75	0.92	1.19	1.40	1.68	2.05	1/8" Weight (Metals) = 7 gms. Approx				
CA16.100	●	●			1.2	0.50	0.71	1.00	1.22	1.58	1.87	2.24	2.74	1/4"	22	10	13	14
CA16.150	●	●			1.5	0.75	1.06	1.50	1.84	2.37	2.81	3.35	4.11	1/4" Weight (Metals) = 18 gms. Approx				
CA16.175	●	●			1.6	0.87	1.24	1.75	2.14	2.77	3.27	3.91	4.79	3/8"	25	12	16	17
CA16.200	●	●			1.7	1.00	1.41	2.00	2.45	3.16	3.74	4.47	5.48	3/8" Weight (Metals) = 28 gms. Approx				
CA16.250	●	●			1.9	1.25	1.77	2.50	3.06	3.95	4.68	5.59	6.85	1/2"	27	13.2	21	22
CA16.300	●	●			2.1	1.5	2.12	3.00	3.67	4.74	5.61	6.71	8.22	1/2" Weight (Metals) = 42 gms. Approx				
CA16.350	●	●			2.3	1.75	2.47	3.50	4.29	5.53	6.55	7.83	9.59					
CA16.400	●	●			2.4	2.00	2.83	4.00	4.90	6.32	7.48	8.94	10.95					
CA16.475	●	●			2.7	2.37	3.36	4.75	5.82	7.51	8.89	10.62	13.00					
CA16.650	●	●			3.1	3.25	4.60	6.50	7.96	10.28	12.16	14.53	17.80					
CA16.800	●	●			3.5	4.00	5.66	8.00	9.80	12.65	14.97	17.89	21.91					
CA26.100		●	●		3.9	5.00	7.07	10.00	12.25	15.81	18.71	22.36	27.39					
CA26.125		●	●		4.3	6.25	8.84	12.50	15.31	19.76	23.39	27.95	34.23					
CA26.160		●	●		4.9	8.00	11.31	16.00	19.60	25.30	29.93	35.78	43.82					
CA26.180		●	●		5.2	9.00	12.73	18.00	22.05	28.46	33.67	40.25	49.30					
CA26.200		●	●		5.5	10.00	14.14	20.00	24.49	31.62	37.42	44.72	54.77					
CA26.225		●	●		5.8	11.25	15.91	22.50	27.56	35.58	42.09	50.31	61.62					
CA26.250		●	●		6.1	12.50	17.68	25.00	30.62	39.53	46.77	55.90	68.47					
CA26.320			●	●	6.4	16.00	22.63	32.00	39.19	50.60	59.87	71.55	87.64					
CA26.400			●	●	7.8	20.00	28.28	40.00	48.99	63.25	74.83	89.44	109.54					
CA26.520				●	8.9	26.00	36.77	52.00	63.69	82.22	97.28	116.28	142.41					
CA26.650				●	9.9	32.50	45.96	65.00	79.61	102.77	121.60	145.34	178.00					
CA26.800				●	11.0	40.00	56.57	80.00	97.98	126.49	149.67	178.89	219.09					

120° SPRAY ANGLE	END CONNECTION				ORIFICE SIZE (mm)	FLOW CAPACITY IN LPM AT DIFFERENT PRESSURE VALUES								G/A DIMENSION. MM				
	1/8"	1/4"	3/8"	1/2"		PRESSURE [BAR]												
MODEL NO.	BSP BSPT NPT	BSP BSPT NPT	BSP BSPT NPT	BSP BSPT NPT		0.5	1.0	2.0	3.0	5.0	7.0	10.0	15.0	CONN.	H	H1	D	HEX
CA18.050	●	●			0.8	0.25	0.35	0.50	0.61	0.79	0.94	1.12	1.37	1/8"	18	6.5	10	11
CA18.075	●	●			1.0	0.37	0.53	0.75	0.92	1.19	1.40	1.68	2.05	1/8" Weight (Metals) = 7 gms. Approx				
CA18.100	●	●			1.2	0.50	0.71	1.00	1.22	1.58	1.87	2.24	2.74	1/4"	22	10	13	14
CA18.150	●	●			1.5	0.75	1.06	1.50	1.84	2.37	2.81	3.35	4.11	1/4" Weight (Metals) = 18 gms. Approx				
CA18.175	●	●			1.6	0.87	1.24	1.75	2.14	2.77	3.27	3.91	4.79	3/8"	25	12	16	17
CA18.200	●	●			1.7	1.00	1.41	2.00	2.45	3.16	3.74	4.47	5.48	3/8" Weight (Metals) = 28 gms. Approx				
CA18.250	●	●			1.9	1.25	1.77	2.50	3.06	3.95	4.68	5.59	6.85	1/2"	27	13.2	21	22
CA18.300	●	●			2.1	1.5	2.12	3.00	3.67	4.74	5.61	6.71	8.22	1/2" Weight (Metals) = 42 gms. Approx				
CA18.350	●	●			2.3	1.75	2.47	3.50	4.29	5.53	6.55	7.83	9.59					
CA18.400	●	●			2.4	2.00	2.83	4.00	4.90	6.32	7.48	8.94	10.95					
CA18.475	●	●			2.7	2.37	3.36	4.75	5.82	7.51	8.89	10.62	13.00					
CA18.650	●	●			3.1	3.25	4.60	6.50	7.96	10.28	12.16	14.53	17.80					
CA18.800	●	●			3.5	4.00	5.66	8.00	9.80	12.65	14.97	17.89	21.91					
CA28.100		●	●		3.9	5.00	7.07	10.00	12.25	15.81	18.71	22.36	27.39					
CA28.125		●	●		4.3	6.25	8.84	12.50	15.31	19.76	23.39	27.95	34.23					
CA28.160		●	●		4.9	8.00	11.31	16.00	19.60	25.30	29.93	35.78	43.82					
CA28.180		●	●		5.2	9.00	12.73	18.00	22.05	28.46	33.67	40.25	49.30					
CA28.200		●	●		5.5	10.00	14.14	20.00	24.49	31.62	37.42	44.72	54.77					
CA28.225		●	●		5.8	11.25	15.91	22.50	27.56	35.58	42.09	50.31	61.62					
CA28.250		●	●		6.1	12.50	17.68	25.00	30.62	39.53	46.77	55.90	68.47					
CA28.320			●	●	6.4	16.00	22.63	32.00	39.19	50.60	59.87	71.55	87.64					
CA28.400			●	●	7.8	20.00	28.28	40.00	48.99	63.25	74.83	89.44	109.54					